

Denver, CO

## Denver Station Area TOD Initiative and Policy Development



In recent years, some two dozen light rail stations have been built in the City of Denver. As part of the FasTracks program of regional rail expansion, multiple light and commuter rail stations will be added over the coming years. In an effort to proactively address development around these stations, the City and County of Denver sought technical assistance in developing citywide policies and specific station area plans.

Nelson\Nygaard has led in the area of parking policy, developing station parking policy guidelines and a TOD (transit-oriented development) parking “toolbox.” These have been supported by documentation of best practices in balancing competing demands for multimodal access to stations, cost-effective transit operations, and development of dense, mixed-use communities in the areas surrounding stations. The work has addressed issues such as parking “spillover” into adjacent neighborhoods, traffic mitigation, and strategies for pricing of patron parking, as well as design issues such as parking placement.

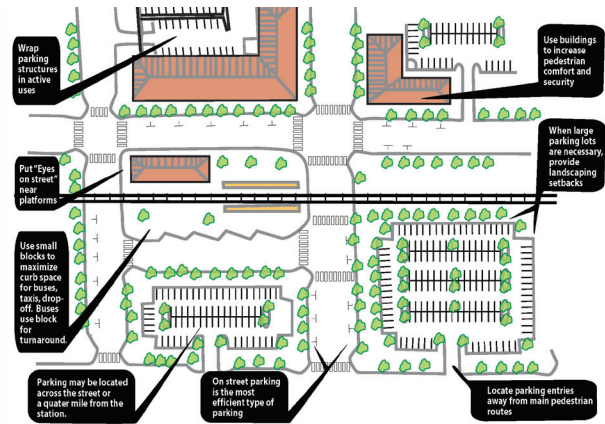

**Project Duration:** 2006–Present

**Total Budget:** \$1,000,000

**Nelson\Nygaard Budget:** \$50,000

**For more information:**

City and County of Denver  
Community Planning and Development  
201 West Colfax Avenue, Dept. 209  
Denver, CO 80202

**Contact:**

Crissy Fanganello  
Denver Department of Public Works  
720-865-3026  
crissy.fanganello@denvergov.org